

10 581 300 00 EUPHORIA PUREFOAM SHOWER SYSTEM WITH THERMOSTAT FOR WALL MOUNTING

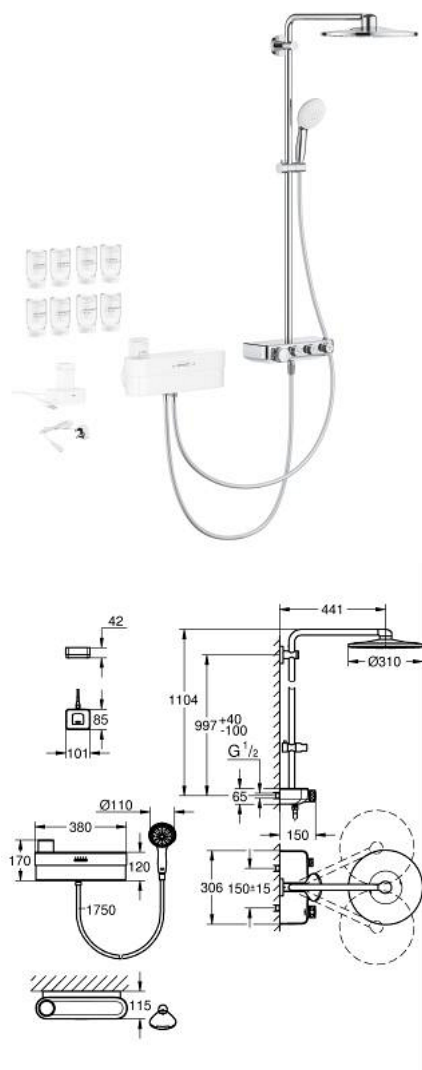

PRODUCT DESCRIPTION

- Colour: chrome
- consisting of:
 - GROHE Purefoam device in white with glass top cover
 - including lithium-ion rechargeable battery (103385), charger with power plug Type C (103384) and Type G (103386) and soaps starter kit (fragrances: Mint 250 ml, Marine 2 x 250 ml, Citrus 2 x 250 ml, Blossom 2 x 250 ml, Water lily 2 x 250 ml)
 - GROHE Purefoam - enveloping shower experience with instant warm foam
- Euphoria SmartControl system 310 Duo
- including horizontal 450 mm shower arm
- upper bracket adjustable for minimal adaption to existing drilling holes
- exposed SmartControl thermostat with integrated GROHE EasyReach shower tray
- allows change between:
 - head shower Rainshower SmartActive 310, 2 spray patterns: GROHE PureRain, ActiveRain, and hand shower
 - GROHE Purefoam 110 hand shower 2 sprays (Rain, Jet) with white sprayface (107 298)
- Silverflex shower hose 1250 mm 1/2" x 1/2" (28 362)
- Silverflex shower hose 1750 mm 1/2" x 1/2" (28 388)
- maximum flow rate (at 3 bar): 16 l/min
- GROHE Purefoam device suitable for screwing (including screws and dowels) or gluing (glue 40 915 000 sold separately - 4 x needed)
- holding force: max. 5 kg
- the specified holding capacity is valid for static (slowly applied) load and intended use only

10 581 300 00 EUPHORIA PUREFOAM SHOWER SYSTEM WITH THERMOSTAT FOR WALL MOUNTING

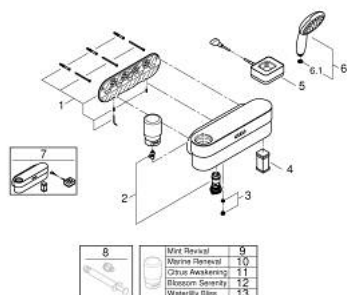

SPARE PARTS, januar 2024 – now

- 1: Fixing set (Spare part-nr. 107444K000)
- 2: Filter set (Spare part-nr. 107442LN00)
- 3: Flow restrictor + inlet filter (Spare part-nr. 1074439990)
- 4: Battery (Spare part-nr. 1033859990)
- 5: Charger (Spare part-nr. 1033849990)
- 6: Hand shower 2 sprays (Spare part-nr. 1072980000)
- 6.1: Dirt strainer (Spare part-nr. 0700200M)
- 7: Exchange device (Spare part-nr. 107445LN00)
- 8: Glue for bath accessories (Spare part-nr. 40915000)*
- 9: Foaming body soap Mint/refreshing (Spare part-nr. 1033699990)*
- 10: Foaming body soap Marine/moisturizing (Spare part-nr. 1033809990)*
- 11: Foaming body soap Citrus/invigorating (Spare part-nr. 1033819990)*
- 12: Foaming body soap Blossom/nourishing (Spare part-nr. 1033829990)*
- 13: Foaming body soap Water lily/calming (Spare part-nr. 1033839990)*
- * Optional accessories