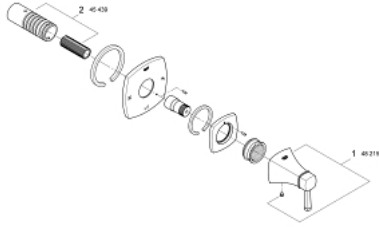

## 19 942 EN0 **GRANDERA 5-WAY DIVERTER**

### **PRODUCT DESCRIPTION**

- Colour: brushed nickel
- set for final installation for
- 29 708 000
- 29 714 000
- without concealed body
- GROHE Long-Life finish
- min. recommended pressure 1.0 bar

19 942 EN0 **GRANDERA 5-WAY DIVERTER**

**SPARE PARTS**, september 2012 – now

1: Grandera handle (Spare part-nr. 48215EN0)

2: Extension (Spare part-nr. 45439000)