

## 22 502 LN0 GROHE SENSE KIT 1 X GROHE SENSE GUARD SMART WATER CONTROLLER + 3 X GROHE SENSE SMART WATER SENSOR

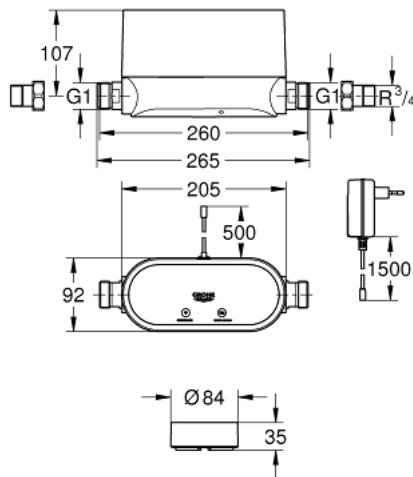

### PRODUCT DESCRIPTION

- Colour: white
- Made in Germany
- 1 x GROHE Sense Guard smart water controller
- for Wi-Fi, mains powered, 230 V
- for single-family houses
- cold water only
- detects pipe breaks, micro leaks, frost risk and unusual water flow
- automatic, manual or remote shut off function to limit water damage
- senses flow rate, water pressure and system temperature
- tracks water consumption
- receive notifications and customize settings via GROHE Sense App
- status indication via LED light, buzzer and push notifications
- Wi-Fi 2.4 GHz, WPA/WPA2 protected
- for horizontal or vertical installation right downstream the water meter
- use of wall mounting set 22 501 000 with G1" connection recommended, sold separately
- including R3/4" mounting nuts, extendable power cable 0.7 m, plug type C
- noise classification I in accordance with DIN 4109
- to be installed on cold water pipes only
- 3 x GROHE Sense smart water sensor
- for Wi-Fi, battery powered
- automatic warnings in emergency situations - flooding alarm and frost risk alarm
- daily updates of humidity and temperature
- receive notifications and customize settings via GROHE Sense App
- status indication via LED light, buzzer and app
- for placement on a flat non-conductive surface
- Wi-Fi 2.4 GHz, WPA/WPA2 protected
- including 9 x AAA batteries
- CE approved