

26 381 001 TEMPESTA SYSTEM 210 FLEX SHOWER SYSTEM WITH DIVERTER FOR WALL MOUNTING

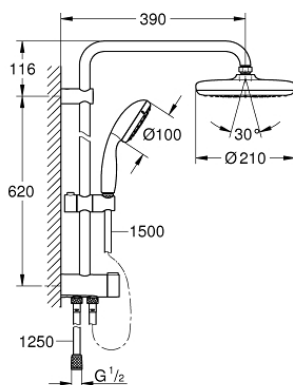

PRODUCT DESCRIPTION

- Colour: chrome
- consisting of:
 - horizontal 390 mm shower arm, adjustable before installation
 - diverter allows change between hand shower, head shower or head shower with reduced flow
 - head shower Tempesta 210 (26 408)
 - 2 spray patterns (via diverter): Rain, SmartRain
 - chrome plated spray face
 - with ball joint
 - rotation angle $\pm 15^\circ$
 - hand shower Tempesta 100 (27 852)
 - spray pattern: Rain
 - adjustable in height with gliding element
 - distance between diverter and upper bracket: 620 mm
 - Relexaflex shower hose 1500 mm (28 151)
 - Relexaflex shower hose 1250 mm (28 150)
 - flexible installation: connection to faucet / wall union for water supply with 1/2" thread of the 1250 mm shower hose
 - GROHE DreamSpray - perfect spray pattern
 - GROHE LongLife finish
 - GROHE SpeedClean - effortless limescale removal
 - Inner WaterGuide - inner insulation for surface protection
 - ShockProof silicone ring prevents damages caused by shower falling
 - suitable for instantaneous heaters from 18 kW/h
 - minimum flow rate 7 l/min



26 381 001 TEMPESTA SYSTEM 210 FLEX SHOWER SYSTEM WITH DIVERTER FOR WALL MOUNTING

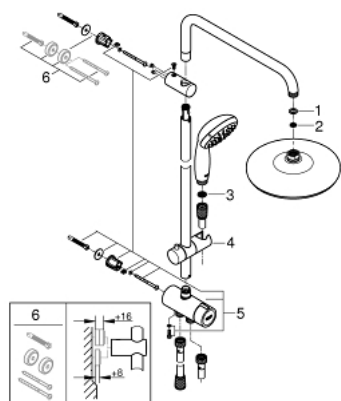

SPARE PARTS, marec 2017 – now

- 1: Fibre seal \varnothing 18,5 x \varnothing 12 x 2 (Spare part-nr. 0138900M)
- 2: Dirt strainer (Spare part-nr. 48007000)
- 3: Dirt strainer (Spare part-nr. 0700200M)
- 4: Glide element (Spare part-nr. 12140000)
- 5: Diverter (Spare part-nr. 48338000)
- 6: Compensation disc (Spare part-nr. 26496000)*

* Optional accessories