

26 693 000 TEMPESTA COSMOPOLITAN SYSTEM 250 CUBE SHOWER SYSTEM WITH SINGLE LEVER BATH MIXER FOR WALL MOUNTING

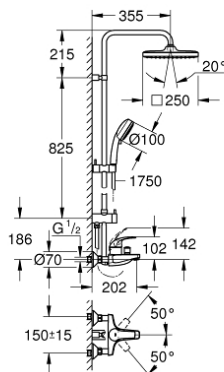

PRODUCT DESCRIPTION

- Colour: chrome
- with short shower rail for installation in showers
- consisting of:
 - horizontal 355 mm shower arm
 - exposed single-lever bath mixer with diverter handle
 - allows change between:
 - head shower Tempesta 250 Cube (26 685)
 - spray pattern: Rain
 - head shower with white rear cover
 - with ball joint, rotation angle $\pm 10^\circ$
 - GROHE EcoJoy 9.5 l/min flow limiter
 - bath inlet
 - separate diverter for hand shower
 - hand shower Tempesta Cosmopolitan 100 (27 575)
 - spray patterns: GROHE Rain O², Rain, Massage, Jet
 - GROHE EcoJoy 9.5 l/min flow limiter
 - adjustable in height with gliding element
 - Rotaflex TwistStop shower hose 1750 mm 1/2" x 1/2" (28 410)
 - GROHE EcoJoy - Less water, perfect flow
 - GROHE SilkMove 46 mm ceramic cartridge
 - GROHE DreamSpray - perfect spray pattern
 - GROHE LongLife finish
 - GROHE SpeedClean - effortless limescale removal
 - Inner WaterGuide - inner insulation for surface protection
 - TwistStop - to prevent hose from twisting
 - suitable for instantaneous heaters from 18 kW/h
 - minimum flow rate 7 l/min
 - min. recommended pressure 1.0 bar
 - professional edition



26 693 000 TEMPESTA COSMOPOLITAN SYSTEM 250 CUBE SHOWER SYSTEM WITH SINGLE LEVER BATH MIXER FOR WALL MOUNTING

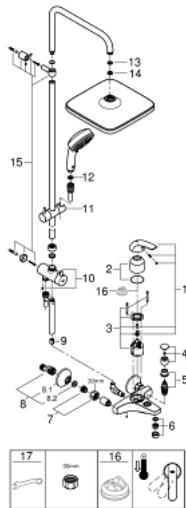

SPARE PARTS, februar 2019 – now

- 1: Lever (Spare part-nr. 46700000)
- 2: Cap (Spare part-nr. 46578000)
- 3: Cartridge (Spare part-nr. 46048000)
- 4: Diverter knob (Spare part-nr. 46571000)
- 5: Diverter (Spare part-nr. 08915000)
- 6: Mousseur (Spare part-nr. 13952000)
- 7: Screw connection 1/2" (Spare part-nr. 45044000)
- 8: S-union (Spare part-nr. 12075000)
- 8.1: Seal (Spare part-nr. 0138600M)
- 8.2: Escutcheon (Spare part-nr. 0221000M)
- 9: Non-return valve (Spare part-nr. 08565000)
- 10: Diverter (Spare part-nr. 46877000)
- 11: Glide element (Spare part-nr. 46876000)
- 12: Dirt strainer (Spare part-nr. 0700200M)
- 13: Fibre seal Ø 18,5 x Ø 12 x 2 (Spare part-nr. 0138900M)
- 14: Dirt strainer (Spare part-nr. 48007000)
- 15: Mounting set (Spare part-nr. 46878000)
- 16: Temperature limiter (Spare part-nr. 46375000)*
- 17: Special spanner (Spare part-nr. 19377000)*

* Optional accessories