

31 187 001 **COSTA L WALL SINK MIXER 1/2"**

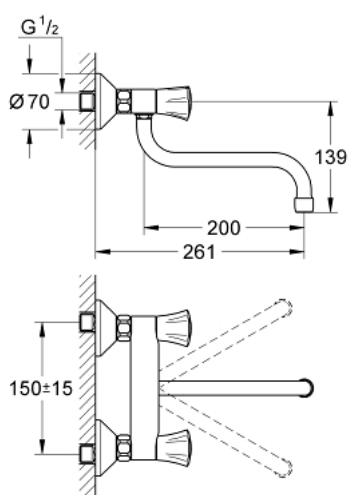

**PRODUCT DESCRIPTION**

- Colour: chrome
- metal handles
- heat insulated
- GROHE Long-Life finish
- GROHE Long-Life headparts
- mousseur
- swivel tubular spout
- swivel area 360°
- projection 200 mm
- S-unions
- maximum flow rate (at 3 bar): 13 l/min



## 31 187 001 **COSTA L WALL SINK MIXER 1/2"**



### **SPARE PARTS**, junij 2007 – now

- 1: Handle (Spare part-nr. 45994000)
- 1.1: Snap insert (Spare part-nr. 0538600M)
- 2: Headpart 1/2" (Spare part-nr. 07146000)
- 2.1: Sealing washer Ø 6 x Ø 2 (Spare part-nr. 0128300M)
- 2.2: O-ring Ø 18.2 x Ø 1.7 (Spare part-nr. 0392400M)
- 2.3: Seal (Spare part-nr. 0529100M)
- 3: Screw connection 1/2" (Spare part-nr. 45044000)
- 4: S-union (Spare part-nr. 12075000)
- 4.1: Seal (Spare part-nr. 0138600M)
- 4.2: Escutcheon (Spare part-nr. 0221000M)
- 5: Tubular spout (Spare part-nr. 13051000)
- 5.1: O-ring Ø 12 x Ø 2 (Spare part-nr. 0128000M)
- 5.2: Mousseur (Spare part-nr. 13928000)
- 6: Extension 3/4", 20 mm (Spare part-nr. 0713000M)\*
- 7: Screw for Costa/Avina products (Spare part-nr. 48013000)\*

\* Optional accessories