

## 31 656 AT0 K200 COMPOSITE SINK

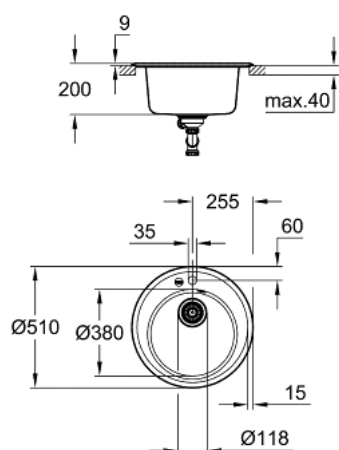

### PRODUCT DESCRIPTION

- Colour: granite gray
- model: K200 50-C 51 1.0
- mounting type: top mount
- material: quartz composite
- GROHE Whisper
- min. cabinet size: 500 mm
- dimensions: Ø 510 mm
- 1 bowl: Ø 380 x 200 mm
- inner bowl radius: Ø 380
- GROHE FastFixation installation system
- cut-out: Ø 490 mm
- drainer: automatic waste fitting
- accessories included: waste kit, basket strainer waste, mounting set
- optional push to open excenter (40 986 SD0)
- amount of fasteners included (top mount): 3
- heat resistant up to 180° C

## 31 656 AT0 **K200 COMPOSITE SINK**

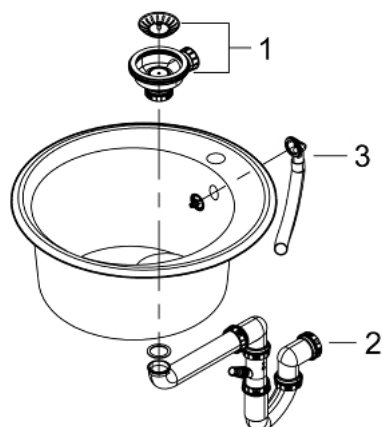

### **SPARE PARTS**, maj 2022 – now

1: Plug (Spare part-nr. 42589SD1)

2: Siphon (Spare part-nr. 42616000)

3: cover element (Spare part-nr. 42621SD0)