

33 341 000 **THREE-HOLE SINGLE-LEVER BATH COMBINATION**

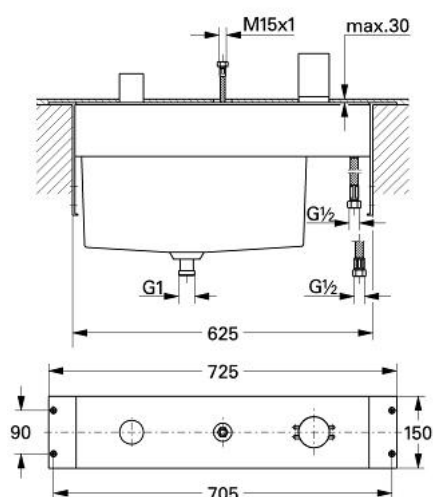

PRODUCT DESCRIPTION

- baseframe for installation under tiled surround
- without finishing trim set
- base frame with cover plate
- GROHE SilkMove 56 mm ceramic cartridge
- concealed installation box with pre-assembled mounting plate
- connection hoses
- shower connection
- drainage box with integrated outlet for splash water
- protected against backflow
- this part should be easy to access.



33 341 000 **THREE-HOLE SINGLE-LEVER BATH COMBINATION**

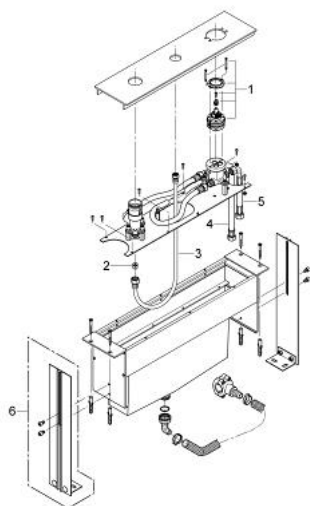

SPARE PARTS, april 2007 – now

- 1: Cartridge (Spare part-nr. 46386000)
- 2: Non-return valve (Spare part-nr. 08565000)
- 3: Connecting hose (Spare part-nr. 07300000)
- 4: Connection hose, 300 mm (Spare part-nr. 07772000)
- 5: Connecting hose (Spare part-nr. 07467000)
- 6: Supporting legs (Spare part-nr. 45388000)*

* Optional accessories