

38 863 000 FLUSHING CISTERN FOR WC 80 MM

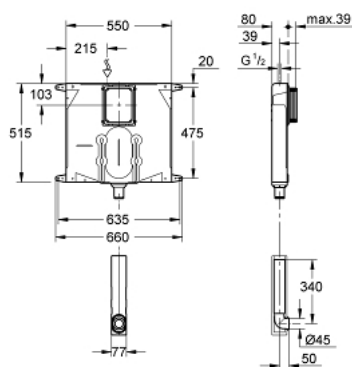

PRODUCT DESCRIPTION

- 6 - 9 l adjustable
- pneumatic discharge valve offering 3 modes of operation: dual flush or start/stop or single flush
- water supply connection from top
- low noise (group I acc. to German Noise Specification)
- with push fit flexible hose union
- angle valve 1/2"
- shortable inspection shaft including protection during construction phase, for vertical use
- fixing brackets
- without flush plate/actuation
- GROHE Water Saving - Less water, perfect flow
- for mounting of small flush plates please order revision shaft 40 949 000 (sold separately)



38 863 000 FLUSHING CISTERN FOR WC 80 MM

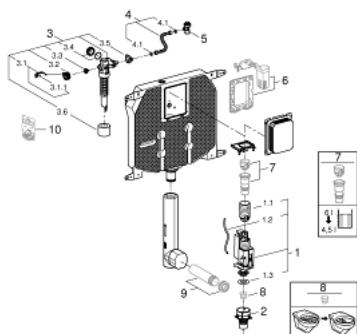

SPARE PARTS, maj 2021 – now

- 1: Dual Flush discharge valve AV1 (Spare part-nr. 42320000)
- 1.1: Extension for overflow pipe (Spare part-nr. 42313000)
- 1.2: Pneumatic hose (Spare part-nr. 42319000)
- 1.3: Seal (Spare part-nr. 42310000)
- 2: Valve seat for GD2 (Spare part-nr. 42315000)
- 3: Filling valve (Spare part-nr. 43991000)
- 3.1: Valve support (Spare part-nr. 43995000)
- 3.2: Lever (Spare part-nr. 43734000)
- 3.2.1: Seal (Spare part-nr. 4377000M)
- 3.3: Valve head (Spare part-nr. 43536000)
- 3.4: Membrane (Spare part-nr. 4375800M)
- 3.5: Screw cap (Spare part-nr. 43735000)
- 3.6: Valve float, 5 pcs. (Spare part-nr. 4379100M)
- 4: Connecting hose (Spare part-nr. 42233000)
- 4.1: Sealing washer (Spare part-nr. 0319100M)
- 5: Angle valve (Spare part-nr. 42343000)
- 6: Retrofit set (Spare part-nr. 38796000)*
- 7: 4.5 l adapter for GD2 (Spare part-nr. 42333000)*
- 8: Flow restrictor (Spare part-nr. 42300000)*
- 9: WC inlet and outlet connecting set (Spare part-nr. 37311K00)*
- 10: Set of seals (Spare part-nr. 43722000)*

* Optional accessories