

39 972 000 **NOVA COSMOPOLITAN LIGHT FLUSH PLATE**

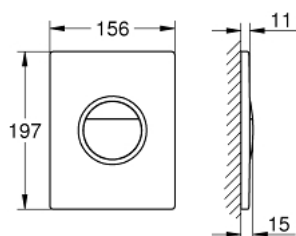

PRODUCT DESCRIPTION

- Colour: chrome
- for dual flush or start & stop actuation
- external highlighted outline
- with LEDs in blue, red, yellow, green
- light colour individually adjustable
- on/off button
- timer for individual regulation of illuminating period
- 3 m connecting cable
- transformer for external installation
- operating voltage 230 V AC
- 50/60 Hz, 2.0 VA
- CE approved
- for pneumatic discharge valve AV1
- vertical and horizontal installation
- 156 x 197 mm
- material: ABS
- GROHE Long-Life finish
- GROHE Water Saving - Less water, perfect flow
- for combination with Rapid SL and Uniset with GD 2 cistern
- for use with Rapid SLX please order shaft 66 791 000 (sold separately)

39 972 000 **NOVA COSMOPOLITAN LIGHT FLUSH PLATE**

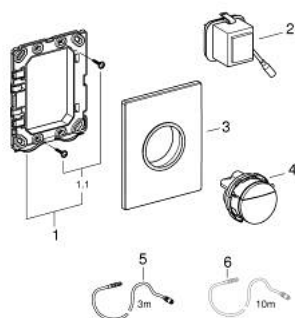

SPARE PARTS, oktober 2021 – now

- 1: Mounting frame (Spare part-nr. 42358000)
- 1.1: Screw (Spare part-nr. 6636200M)
- 2: Switching power supply (Spare part-nr. 66960000)
- 3: Top plate with electronic (Spare part-nr. 42359000)
- 4: Push button (Spare part-nr. 48614000)
- 5: Extension cable (Spare part-nr. 36221000)
- 6: Extension cable (Spare part-nr. 36222000)*
- * Optional accessories